



- 1 NEWTOWN COMMUNITY & SENIOR CENTER
- 2 NEWTOWN MUNICIPAL CENTER
- 3 NEWTOWN YOUTH ACADEMY
- 4 KENT HOUSE
- 5 SHELTON HOUSE
- 6 WOODBURY HALL*
- 7 NEWTOWN HALL*
- 8 STAMFORD HALL
- 9 PLYMOUTH HALL
- 10 COCHRAN HOUSE
- 11 STRATFORD HALL*



NEWTOWN COMMUNITY & SENIOR CENTER DESIGN DEVELOPMENT

BOARD OF SELECTMEN
June 20, 2017

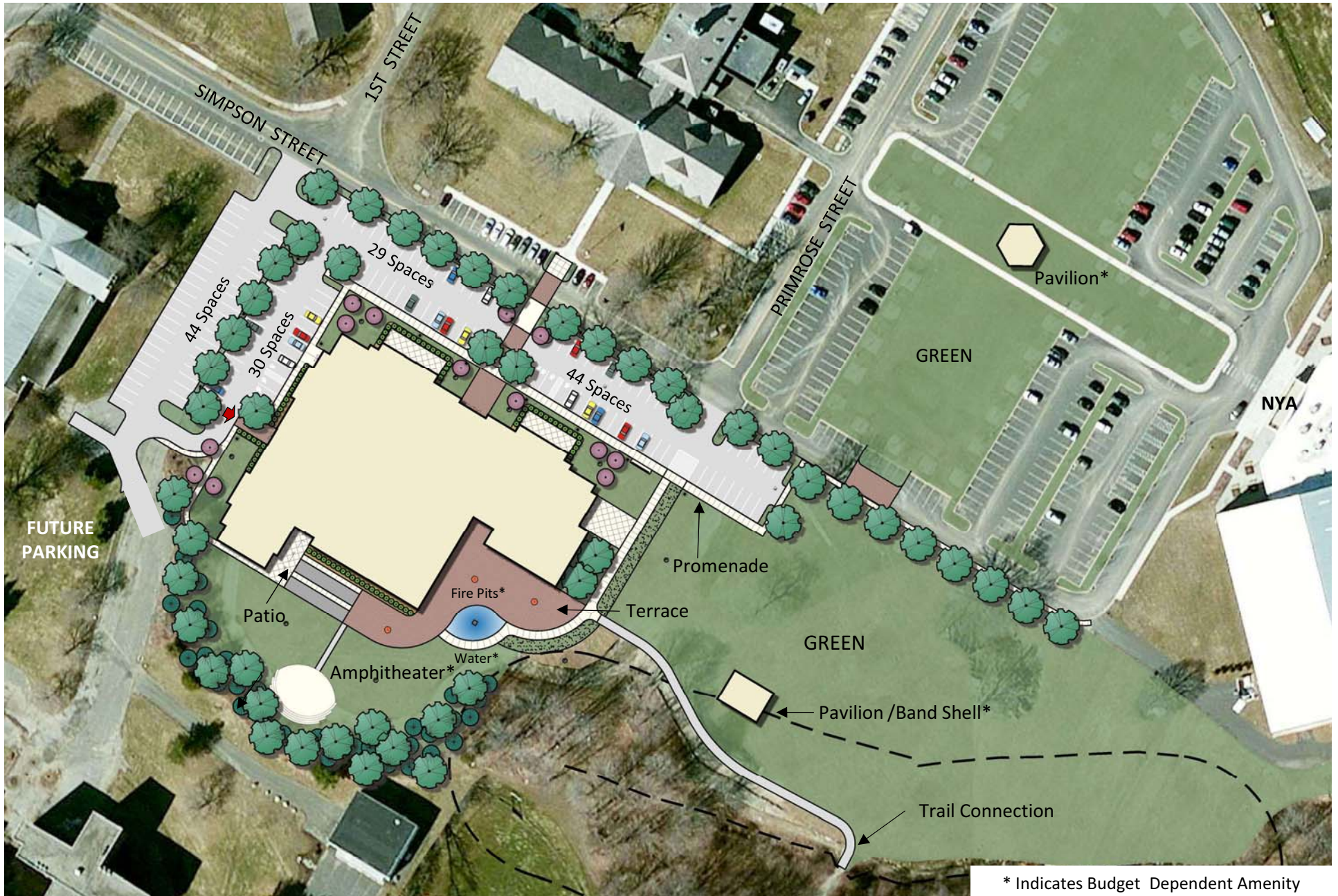

NEWTOWN COMMUNITY & SENIOR CENTER SITE MASTER PLAN

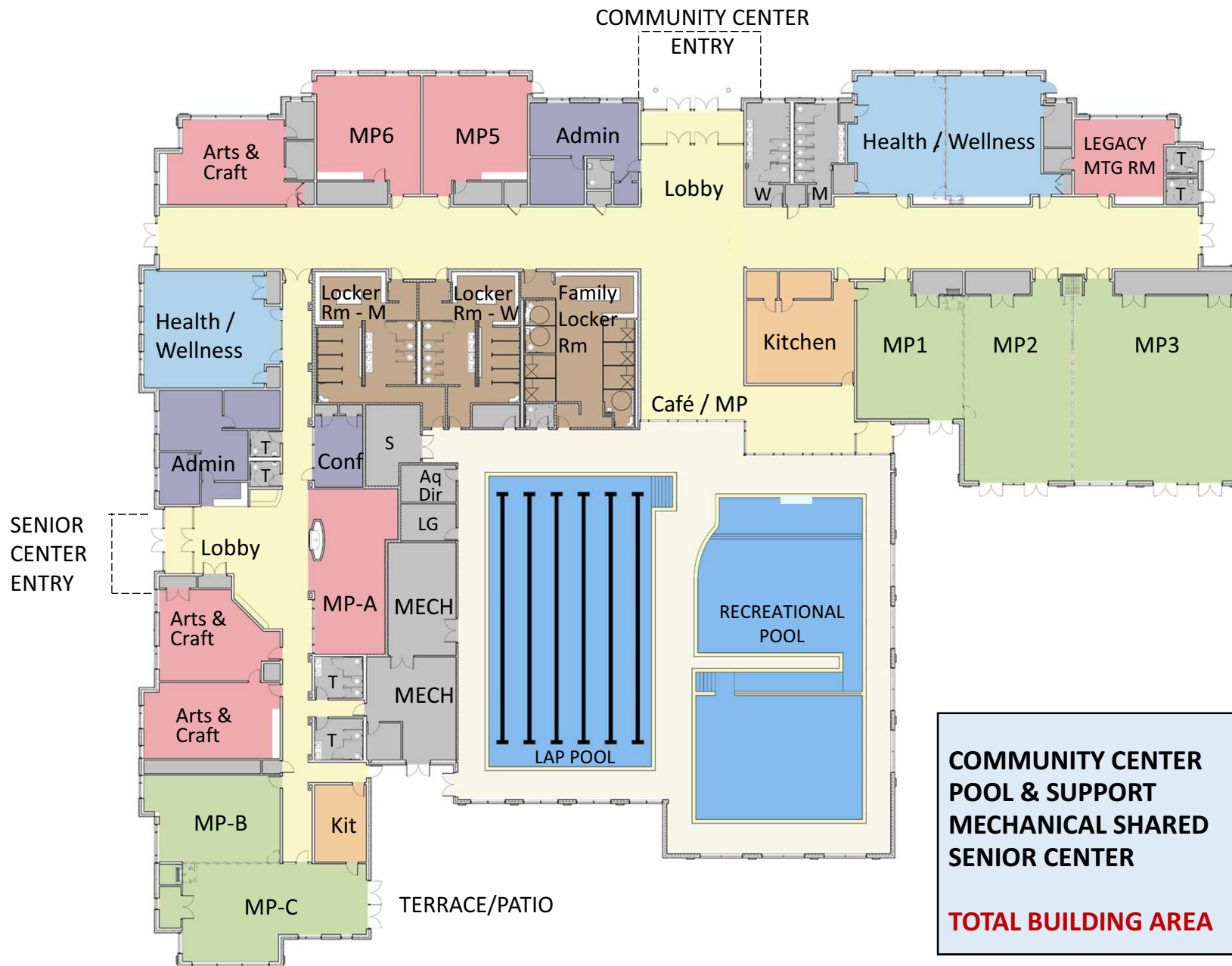

COMMUNITY CENTER	17,535 GSF
POOL & SUPPORT	17,675 GSF
MECHANICAL SHARED	1,000 GSF
SENIOR CENTER	<u>9,450 GSF</u>
TOTAL BUILDING AREA	45,860 GSF



NEWTOWN COMMUNITY & SENIOR CENTER

BUILDING PLAN

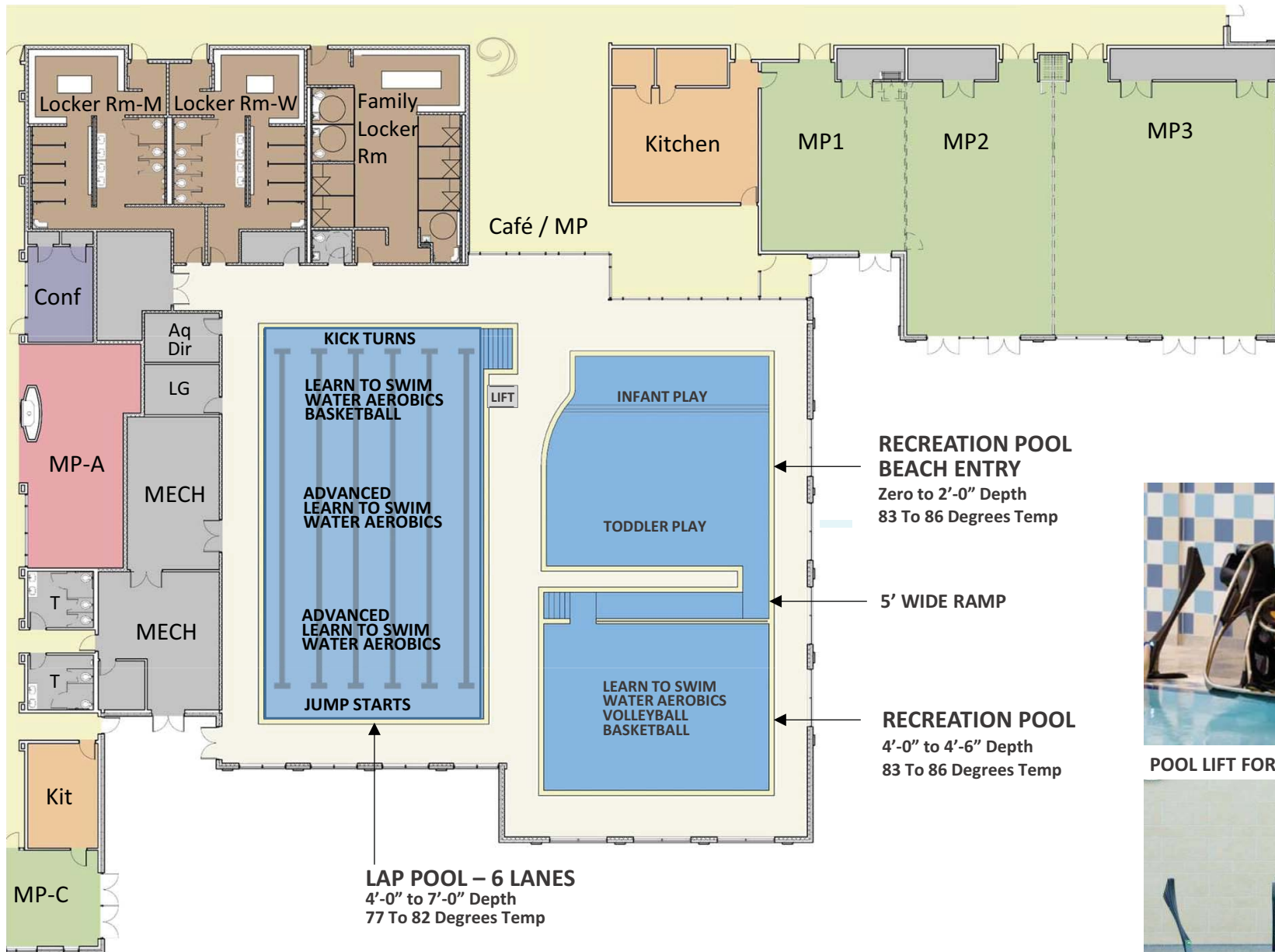

POOL LIFT FOR ACCESSABILITY



NEWTOWN COMMUNITY & SENIOR CENTER

POOL DESIGN

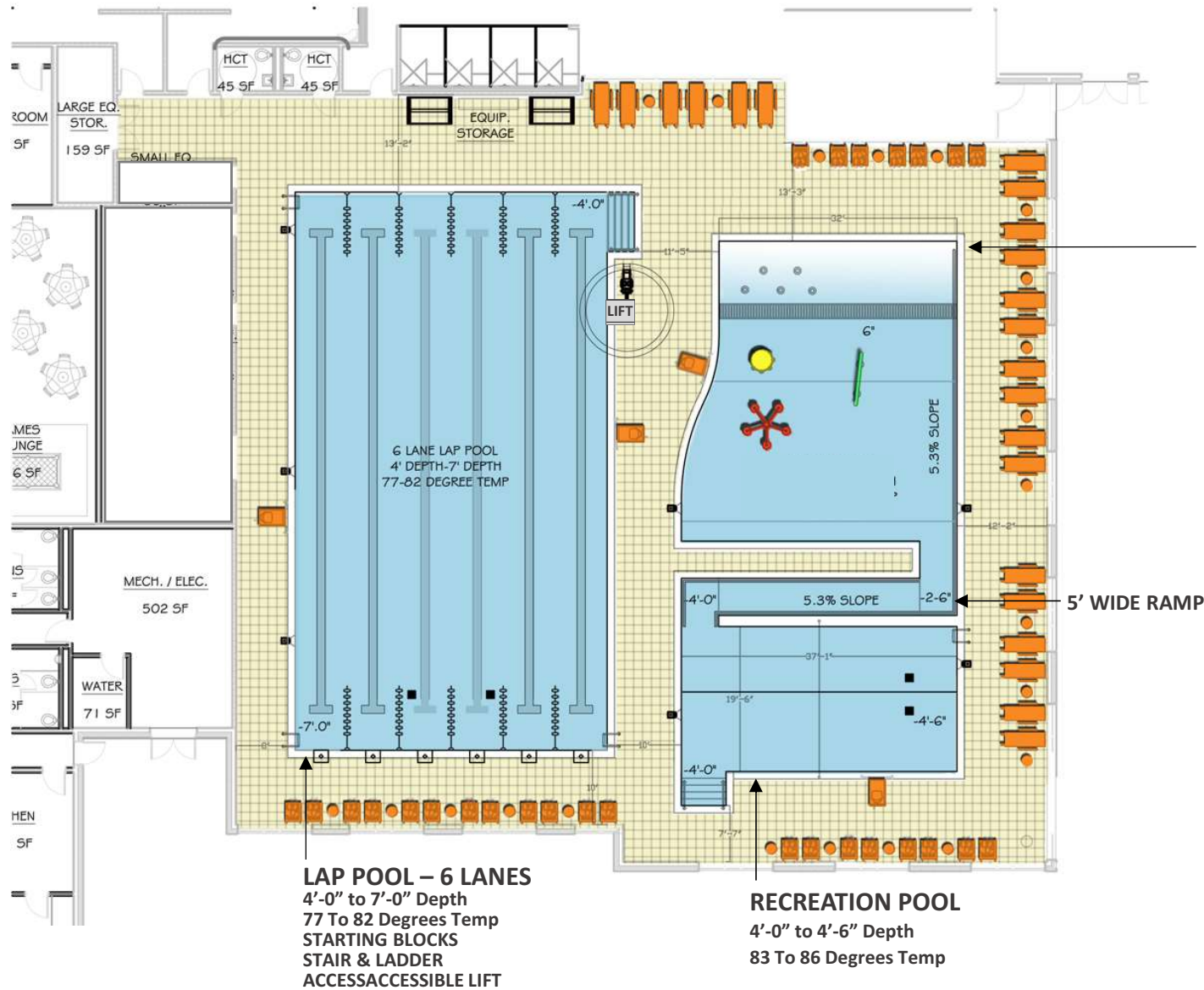

POOL LIFT FOR ACCESSABILITY



NEWTOWN COMMUNITY & SENIOR CENTER

POOL DESIGN



NEWTOWN COMMUNITY & SENIOR CENTER

DESIGN OPTIONS



COMMUNITY CENTER ENTRANCE



SOUTHEAST ELEVATION / PERSPECTIVE



NEWTOWN COMMUNITY & SENIOR CENTER

BUILDING DESIGN



EAST ELEVATION / PERSPECTIVE



SOUTH ELEVATION / PERSPECTIVE



NEWTOWN COMMUNITY & SENIOR CENTER

BUILDING DESIGN



NEWTOWN COMMUNITY & SENIOR CENTER

BUILDING DESIGN



NEWTOWN COMMUNITY & SENIOR CENTER

COMMUNITY CENTER
MAIN CORRIDOR



WEST ELEVATION / PERSPECTIVE



NEWTOWN COMMUNITY CENTER

DESIGN OPTIONS



SENIOR CENTER ENTRANCE



WEST ELEVATION / PERSPECTIVE



NEWTOWN COMMUNITY CENTER

DESIGN OPTIONS



NEWTOWN COMMUNITY & SENIOR CENTER

SENIOR CENTER
MAIN ENTRY LOBBY