

Juniper Road and Birch Rise Drive
Traffic Flow Recommendations
CFS#1700022245



Completed by Ofc. Benjamin Mulhall
Newtown Department of Police Services
Traffic Unit

Overview

The Newtown Police Departments Traffic Unit was requested to come up with a solution for the excessive traffic traveling down Juniper Road and Birch Rise Drive, due to the ongoing construction at the intersection of RT302(Sugar Street) and Elm Drive. This construction is slated to last into late 2018. This request came from a complaint from a resident on Birch Rise Drive that was brought up at the November 7th Police Commissioners meeting.

Location Details

Juniper Road is a dead end, town roadway that is approximately 1900 feet long. The roadway currently does not have a state approved speed limit and an application for a 25mph is will be summited. There are 17 houses with driveway exits onto Juniper Road.

Birch Rise Drive is a town owned roadway that connects Juniper Road and Elm Drive and is approximately 1000 feet long. The roadway currently does not have a state approved speed limit and an application for a 25mph speed limit will be summited. There are 14 houses whose driveways access Birch Rise Drive.

Complaint

The complaint, Mike Mandarano of 9 Birch Rise Drive, stated that since the town had attempted to put up a display sign on RT302 to inform people not to use Juniper Rd and Birch Rise Dr. as a cut through traffic has been worse and people are speeding.

Options

There are several possible options to address this complaint. One option would be to temporarily make Birch Rise Dr. a ONE WAY street, with traffic flowing from Elm Dr. to Juniper Rd. Do not enter signs (R5-1 in the MUTCD) would need to be placed at the intersection of Birch Rise Dr. and Juniper Rd, one on each side of Birch Rise Dr. facing Juniper Rd. Also two No Outlet signs (W14-2 in the MUTCD) would be placed at the intersection of Juniper Rd and RT302(Sugar Street), one on each side of the roadway.

Second option would be to make Juniper Rd a ONE WAY street between RT302 and Nettleton Ave. with traffic flowing from Nettleton Ave to RT302. DO NOT ENTER signs (R5-1 in the MUTCD) would be placed at the intersection of Juniper Rd and RT 302. ONE Way signs (R6-1 in the MUTCD) would be placed on Juniper Dr. at the intersection of Nettleton Ave. This option would directly affect 3 houses on Juniper Rd that have driveways on Juniper between RT302 and Nettleton Ave. This option would keep all cut through traffic coming off RT 302 from entering this neighborhood, but could force some residents to drive around to get on to Juniper Rd.

The third option would be to apply for State approved 25MPH speed limits on both Juniper and Birch Rise, and have increased enforcement on the roadways. This option would not address the increased traffic and would be labor intensive.

Recommendation

In reviewing the options, it is the recommendation of the traffic unit to temporarily make Birch Rise Drive a one way street. This option should discourage Juniper and Birch Rise as a detour and reduce the impact of the construction. Residents from Birch Rise will be affected by the temporary change and it is recommended that they be consulted prior to a final decision.

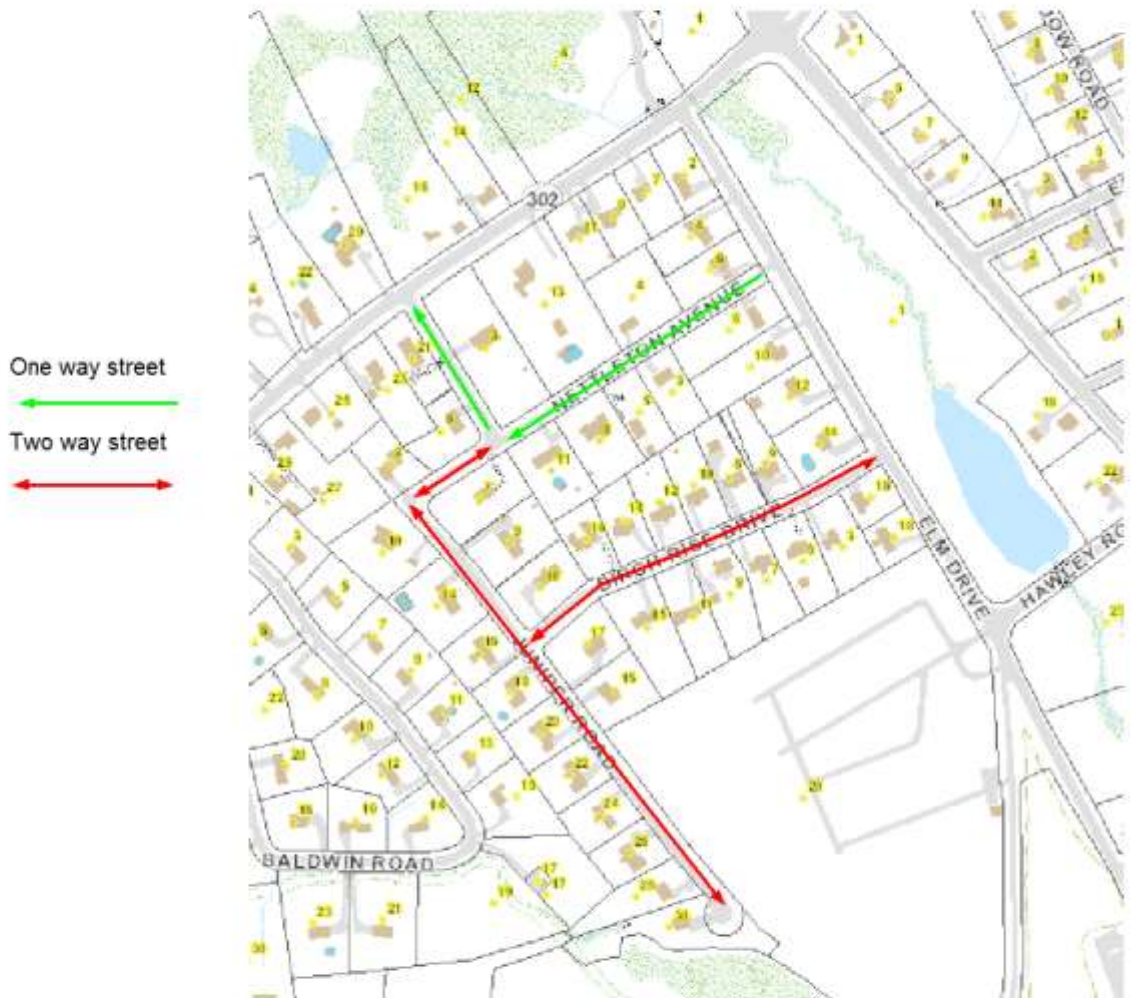

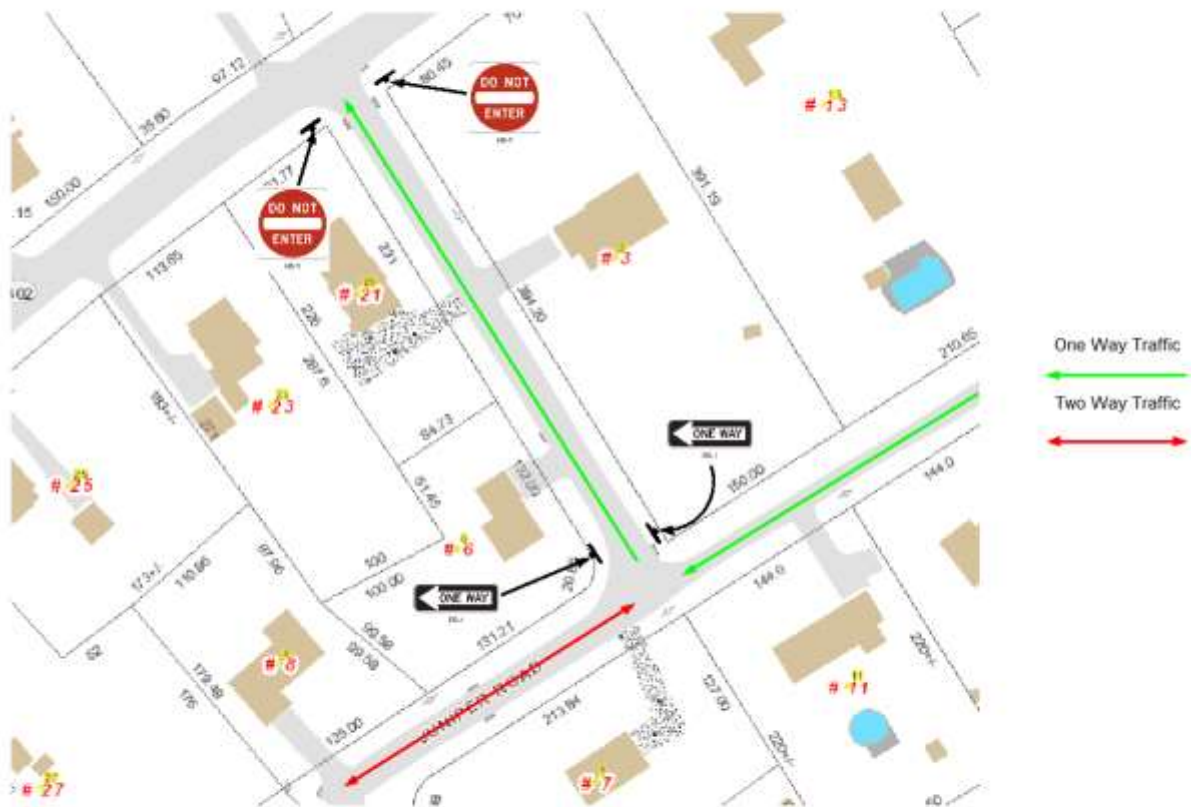

Section 2B.37 DO NOT ENTER Sign (R5-1)

Standard:

The DO NOT ENTER (R5-1) sign (see Figure 2B-11) shall be used where traffic is prohibited from entering a restricted roadway.

Guidance:

The DO NOT ENTER sign, if used, should be placed directly in view of a road user at the point where a road user could wrongly enter a divided highway, one-way roadway, or ramp (see Figure 2B-12). The sign should be mounted on the right-hand side of the roadway, facing traffic that might enter the roadway or ramp in the wrong direction. If the DO NOT ENTER sign would be visible to traffic to which it does not apply, the sign should be turned away from, or shielded from, the view of that traffic.

Option:

The DO NOT ENTER sign may be installed where it is necessary to emphasize the one-way traffic movement on a ramp or turning lane. A second DO NOT ENTER sign on the left-hand side of the roadway may be used, particularly where traffic approaches from an intersecting roadway (see Figure 2B-12).



R5-1

Section 2B.40 ONE WAY Signs (R6-1, R6-2)

Standard:

Except as provided in Paragraph 6, the ONE WAY (R6-1 or R6-2) sign (see Figure 2B-13) shall be used to indicate streets or roadways upon which vehicular traffic is allowed to travel in one direction only.

ONE WAY signs shall be placed parallel to the one-way street at all alleys and roadways that intersect one-way roadways as shown in Figure 2B-14. At an intersection with a divided highway that has a median width at the intersection itself of 30 feet or more, ONE WAY signs shall be placed, visible to each crossroad approach, on the near right and far left corners of each intersection with the directional roadways (see Figure 2B-15). At an intersection with a divided highway that has a median width at the intersection itself of less than 30 feet, Keep Right (R4-7) signs and/or ONE WAY signs shall be installed (see Figures 2B-16 and 2B-17). If Keep Right signs are installed, they shall be placed as close as practical to the approach ends of the medians and shall be visible to traffic on the divided highway and each crossroad approach. If ONE WAY signs are installed, they shall be placed on the near right and far left corners of the intersection and shall be visible to each crossroad approach.



R6-1