



Existing Conditions

Gross Square Footage: 68,333 sf
Built: 1933
of Floors: 1 story, basement
Height of Floors: 1st: 14' to 20'
Walls: Brick
Interior Partitions: Tile, Lath/Plaster
Roof: Asbestos Shingles, Cupola
Heating: Two Pipe Steam Heat, Central heating
Plumbing: Cast iron soil and vent stacks
Air Conditioning: Yes (cafeteria area)
Elevators: Yes, serving three floors
Improvements: Additions on east (1954 & 1960)
Prior Use: Central Food Services



typ. dining hall section



typ. lobby section



typ. dishwash'g section

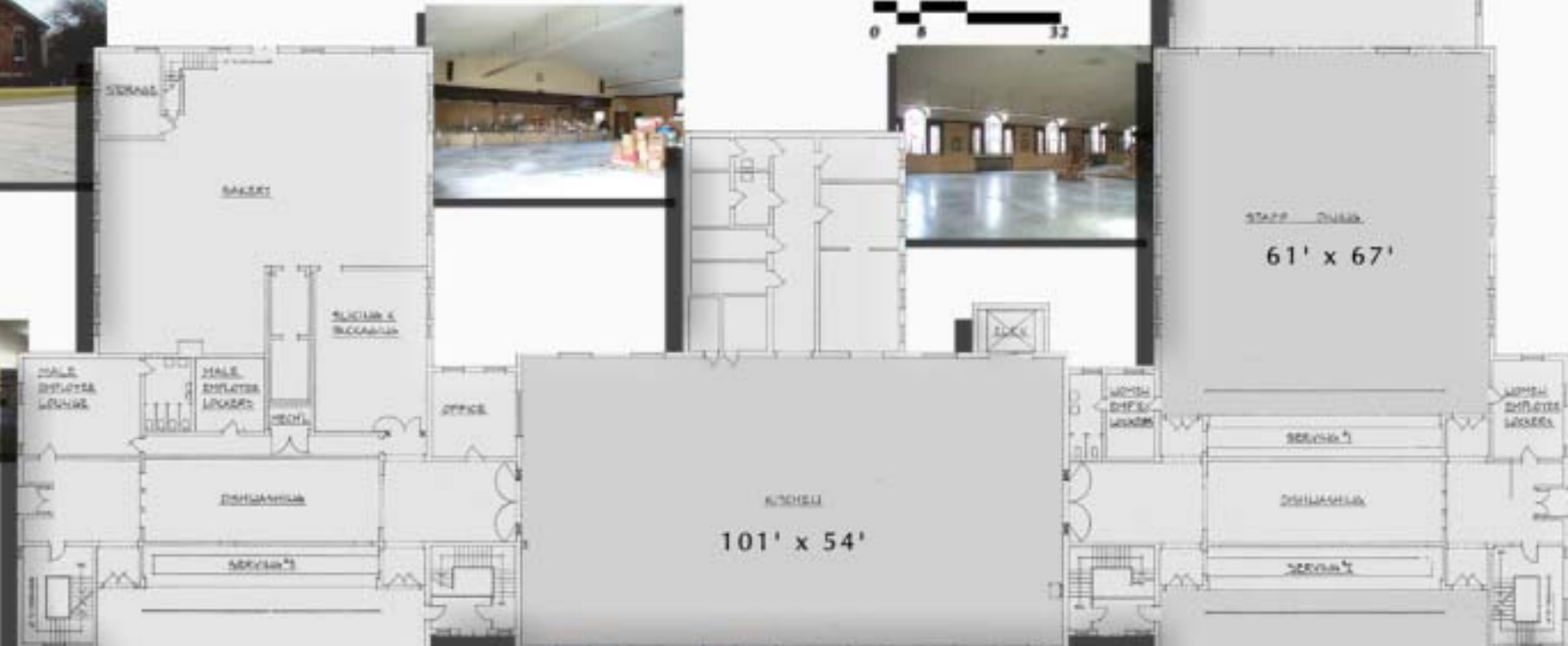
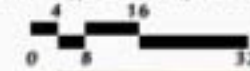

kitchen

first floor plan 0 4 8 16 32



Map Legend

1. Woodbury Hall
2. Newtown Hall
3. Stratford Hall
4. Stamford Hall
5. Norwalk Hall
6. Danbury Hall
7. Shelton House
8. Plymouth Hall
9. Cochran House
10. Canaan House
11. Bridgeport Hall
12. Kent House
13. Greenwich House
14. Yale Laboratory
15. Litchfield House
16. Fairfield House
17. Bridgewater House
- A-E Duplex
- F-N Single Family Dwellings
- P-Q Mechanical

Bridgeport Hall

Fairfield Hills Park
Newtown, Ct

