

Existing Conditions

- Gross Square Footage:** 208,888 sf
Built: 1940
of Floors: 3 stories, attic, basement
Height of Floors: 1st: 11'-3"
 2nd: 11'-3"
 3rd: 11'-3"
Walls: Brick
Interior Partitions: Reinforced Concrete, Tile, Lath/Plaster
Roof: Asbestos Shingles, Cupola
Heating: Two Pipe Steam Heat, Central heating
Plumbing: Cast iron soil and vent stacks
Air Conditioning: Yes
Elevators: Yes, serving three floors
Improvements: Cornice - 1955
 Gutters - 1958
 Repair & repoint brick - 1964
 Cupola repair - 1972
 General Renovation - 1968
 Air Conditioning - 1990
Prior Use: Residence treatment, housing



second floor plan



third floor plan

29' x 14'

15' x 32'

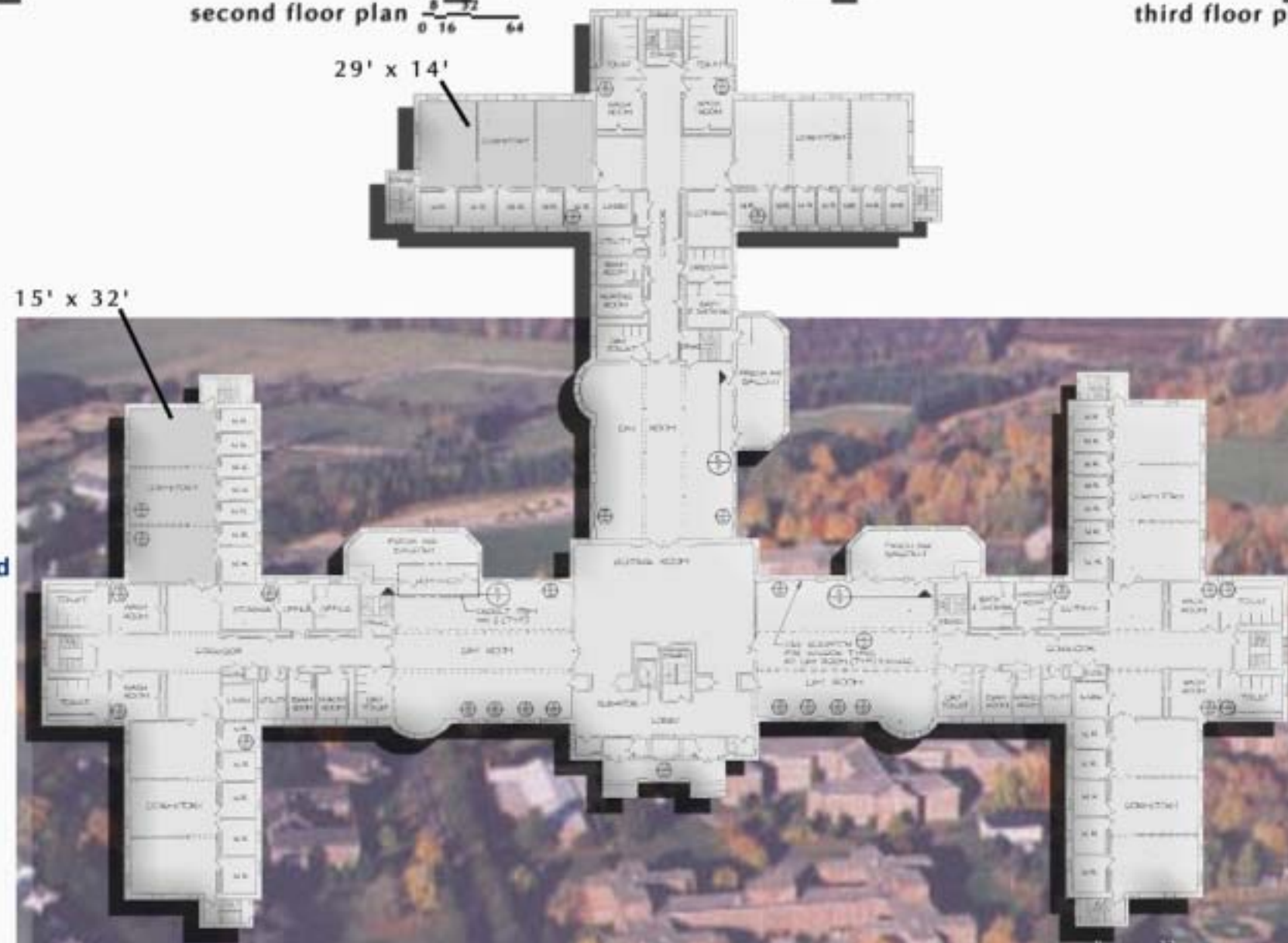

first floor plan

Map Legend

1. Woodbury Hall
2. Newtown Hall
3. Stratford Hall
4. Stamford Hall
5. Norwalk Hall
6. Danbury Hall
7. Shelton House
8. Plymouth Hall
9. Cochran House
10. **Canaan House**
11. Bridgeport Hall
12. Kent House
13. Greenwich House
14. Yale Laboratory
15. Litchfield House
16. Fairfield House
17. Bridgewater House
- A-E Duplex
- F-N Single Family Dwellings
- P-Q Mechanical

Canaan House

Fairfield Hills Park
Newtown, Ct

